



ELECTRONIC PROGRAMMER

Simple and user friendly : digital screen, precise control of temperature
Preset ironing speeds, not adjustable



EFFICIENCY

Acoustic comfort : <55 dB
Minimum space requirement: space saving, suitable for small spaces
Ideal for processing small quantity of flat linen in facilities like restaurants, guest rooms, hostels...



ROBUSTNESS

Nomex quality coating: resistant to high temperatures
Panels in grey skinplate and stainless steel
Wooden feeding board
New kinematics, better reliability
Industrial components, more durable



FEATURES

Large roll contact area with the linen
Automatic roll lifting control by photocell detection
Two available models:
Standard: roll with cotton polyester coating
Nomex: roll with Nomex coating



MAINTENANCE

Easy installation : requires only an electrical connection
Easy access on both sides for maintenance
Quick and easy dismantling of bearings



OTHERS

Front feeding and return
Roll ø 250 mm
Working widths: 1.000 , 1.200, 1.400 and 2.000mm
Electric heating
CE certification

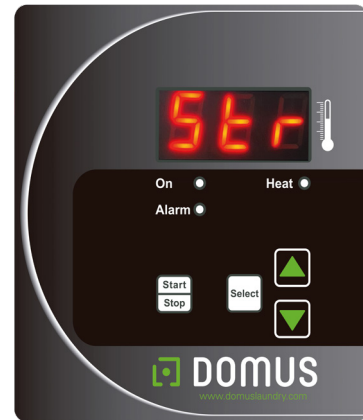
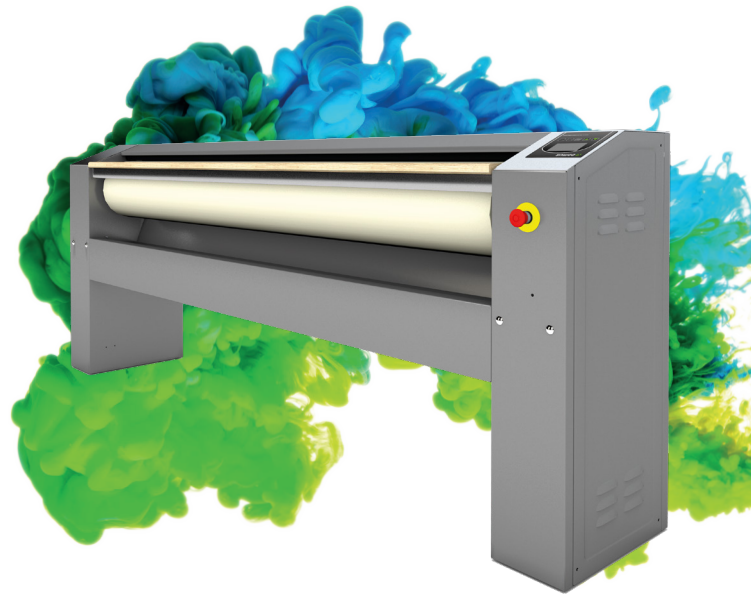

OPTIONS

- Pedal control instead of photocell
- Tension 440V III 60 Hz without N (marine)
- 230V III+T 50-60 Hz
- 230V I+N+T 50 Hz (except model PR-2025)

TECHNICAL DATA	UNIT.	PR-1025	PR-1225	PR-1425	PR-2025
GENERAL DATA					
Theoretical production*	Kg/h	25	27	30	35
Ø Roll	mm	250	250	250	250
Working width	mm	1.000	1.200	1.400	2.000
Ironing speed	m/min	4,2	4,2	4,2	4,2
Electronic programmer	-	Yes	Yes	Yes	Yes
Bed lifting	-	By photocell	By photocell	By photocell	By photocell
POWER					
Heating power	kW	4,95	6	7	12
Roll motor power	kW	0,18	0,18	0,18	0,18
Total electric power	kW	5,13	6,18	7,18	12,18
CONNECTIONS		ELECTRIC	ELECTRIC	ELECTRIC	ELECTRIC
Tension 230V - I + N + T	N°x mm²/A	3 x 6 / 25A	3 x 6 / 32A	3 x 10 / 40A	N/A
Tension 230V - III + T	N°x mm²/A	4 x 2,5 / 16A	4 x 4 / 20A	4 x 4 / 20A	4 x 6 / 32A
Tension 400V - III + N + T	N°x mm²/A	5 x 2,5 / 10A	5 x 2,5 / 10A	5 x 2,5 / 16A	5 x 4 / 20A
OVERALL DIMENSIONS / PACKING DIMENSIONS					
Net / gross width	mm	1.462 / 1.490	1.662 / 1.690	1.862 / 1.890	2.462 / 2.490
Net / gross depth	mm	484 / 540	484 / 540	484 / 540	484 / 540
Net / gross height	mm	985 / 1.130	985 / 1.130	985 / 1.130	985 / 1.130
Net / gross weight	kg	114 / 124	124 / 134	134 / 154	164 / 184
Volume	m3	0,69 / 0,91	0,79 / 1,03	0,89 / 1,15	1,17 / 1,51
OTHERS					
Noise level	dB	55	55	55	55

*20-25% Theoretical production

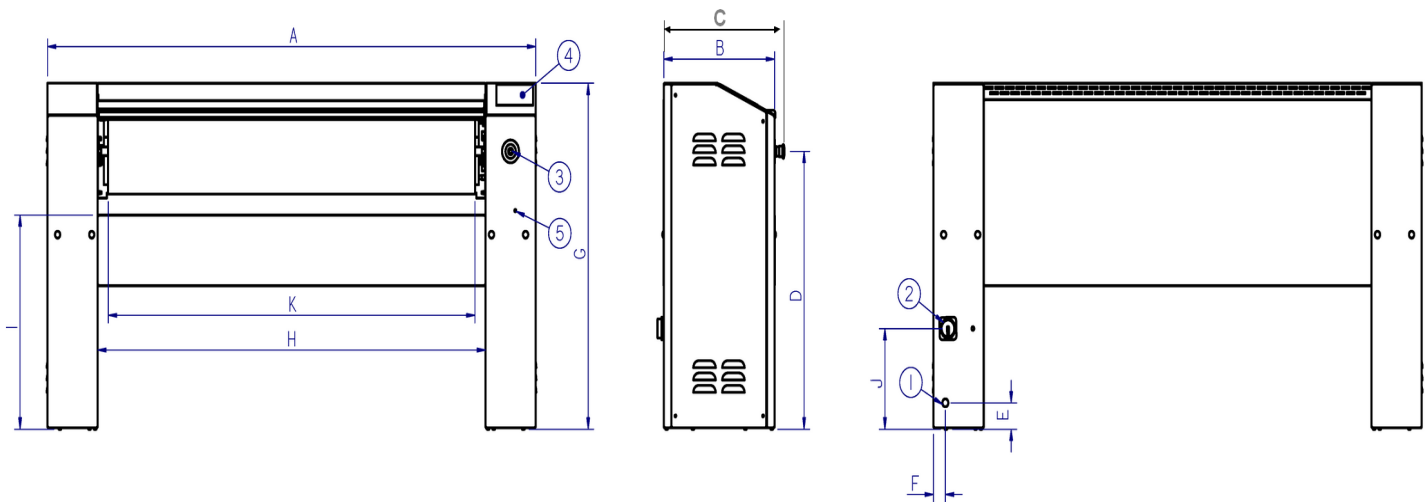

- 01. Electrical connection
- 02. Main switch
- 03. Emergency stop
- 04. Control panel
- 05. access to inverter maintenance

	A	B	C	D	E	F	G	H	I	J	K
PR-1025	1.462	423	484	791	75	45	985	1.079	610	287	998
PR-1225	1.662	423	484	791	75	45	985	1.279	610	287	1.198
PR-1425	1.862	423	484	791	75	45	985	1.479	610	287	1.398
PR-2025	2.462	423	484	791	75	45	985	2.079	610	287	1.998